



NOTES:

1. MATERIAL:
 - 1.1 HOUSING: THERMOPLASTIC, HIGH TEMP., UL94V-0; COLOR:BLACK.
 - 1.2 CONTACT: COPPER ALLOY
2. FINISH:
 - CONTACT:SEE ORDER INFORMATION.
 - UNDERPLATING: 50~100u" NICKEL OVERALL.
3. REFLOW SOLDER CAPABLE TO 260°C PER ACES SPEC.
4. SPEC. PLS. REFER TO PS-52936-xxxxx-xxx
5. PACKAGE PLS. REFER TO 52938-xxxCR-00
6. PART NUMBER

52938-XXX X X -0 0 X

CKTS _____
 050.36+14 PIN _____
 PACKING _____
 0.TAPE REEL _____
 CONTACT PLATING _____
 D.Au 30u" ON CONTACT _____

NO.	PCB T	DIM D	DIM E
1	1.57	1.80	1.35
2	1.93	2.20	1.70
3	2.36	2.60	2.15

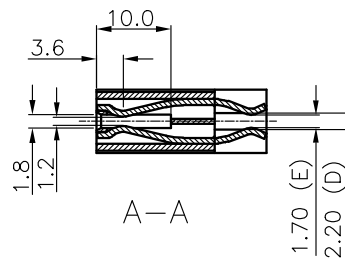
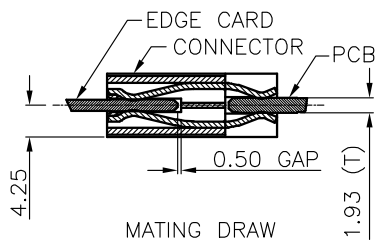
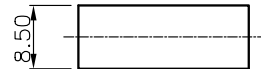
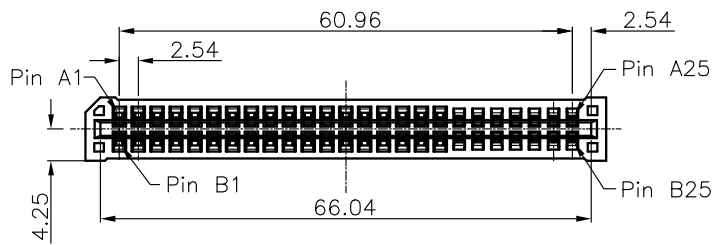
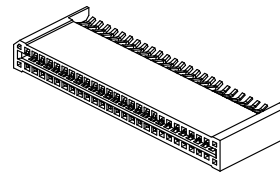
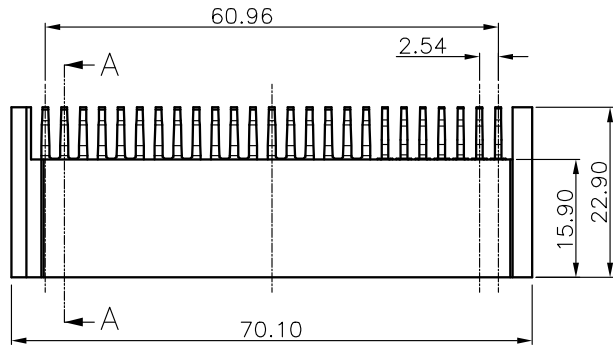

QUALITY SYMBOLS MAJOR Ⓜ CRITICAL Ⓢ GENERAL TOLERANCES (UNLESS SPECIFIED) .X ±0.5 .XX ±0.25 .XXX ±0.1 ANGLES ±2°	DRAWN BY CHEN CHUN YUAN	DATE 19/06/03		TITLE 2.54 mm POWER CONN, STRADDLE TYPE	
	CHECKED BY TSO I HUNG	DATE 19/06/03			RFQ NO. N/A
	APPROVED BY WANG CHUN SHENG	DATE 19/06/03	SIZE A4		REV A
	UNITS mm		SHEET NO. 1 OF 2		DWG NO. 52938-xxxxx-xxx

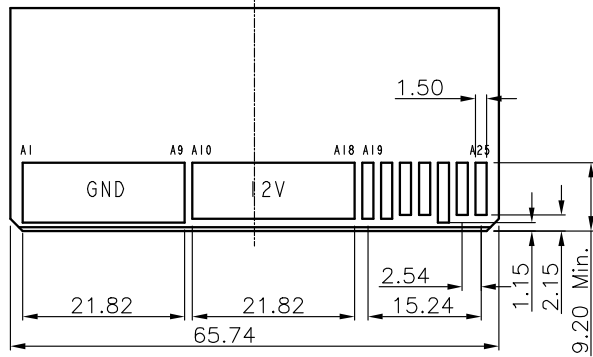

RECOMMEND PCB CARD LAYOUT (TOP VIEW)
THICKNESS IS $T \pm 0.13\text{MM}$; DIMENSION
TOLERANCE: $\pm 0.05\text{MM}$

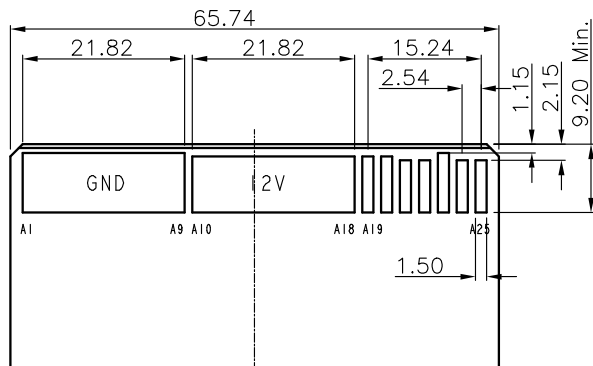

RECOMMEND EDGE CARD LAYOUT (TOP VIEW)
THICKNESS IS $1.57 \pm 0.13\text{MM}$; DIMENSION
TOLERANCE: $\pm 0.05\text{MM}$

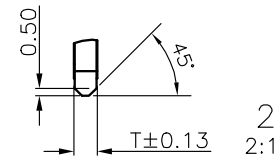
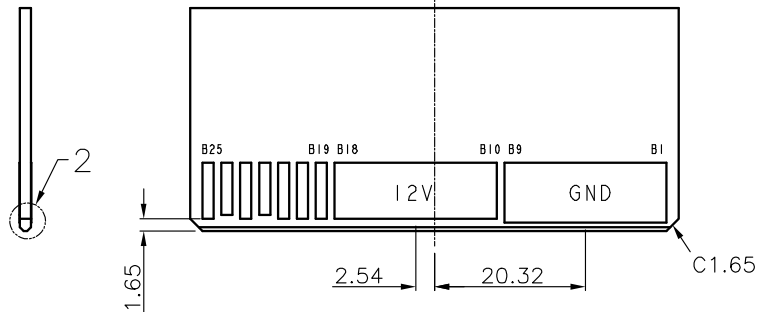

NO.	PCB T
001	1.57
002	1.93
003	2.36

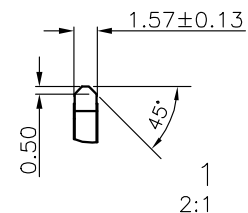
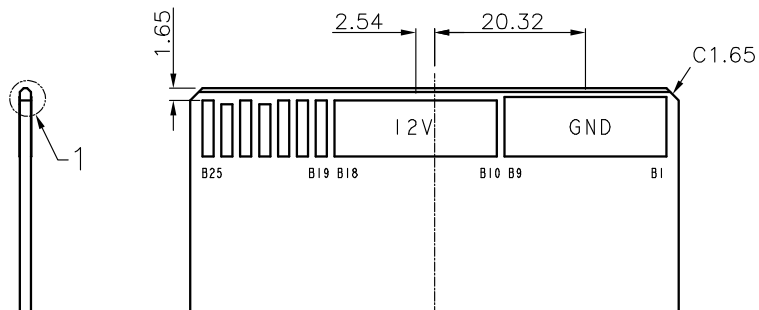

QUALITY SYMBOLS MAJOR CRITICAL GENERAL TOLERANCES (UNLESS SPECIFIED) X. ± 0.5 .X ± 0.25 .XX ± 0.15 .XXX ± 0.1 ANGLES $\pm 2^\circ$	DRAWN BY CHEN CHUN YUAN CHECKED BY TSO I HUNG APPROVED BY WANG CHUN SHENG	DATE 19/06/03 DATE 19/06/03 DATE 19/06/03	 2.54 mm POWER CONN. STRADDLE TYPE RFQ NO. N/A DWG NO. 52938-xxxxx-xxx	
	UNITS mm			SIZE A4
	SCALE 1:1	SHEET NO. 2 OF 2		REV A